



45 Pearse Road AIREYS INLET VIC

3 2 2

Positioned high on the ridgeline overlooking the Aireys Inlet River valley, this superbly appealing residence commands one of the area's most captivating outlooks. The ever changing panorama stretches across the open river valley, the winding river and down the coast to Lorne - a gorgeous 180-degree view that defines the property's unique character. Bathed in sunlight and presented in immaculate order, this three-bedroom coastal retreat captures the relaxed essence of Aireys Inlet living. The home's elevated position and clever design ensure light, warmth and spectacular scenery fill every room. The open plan living and dining area with its access to a large sundeck feels like you are in a living in a treehouse with the resident Kookaburras for company. The sunsets from here are

Type : House
Land Size : 664 sqm
View : <https://www.greateoceanproperties.com.au/8527666>



Marty Maher
0352200000



Michelle McDonald
0352200000

[For full version visit the website](#)

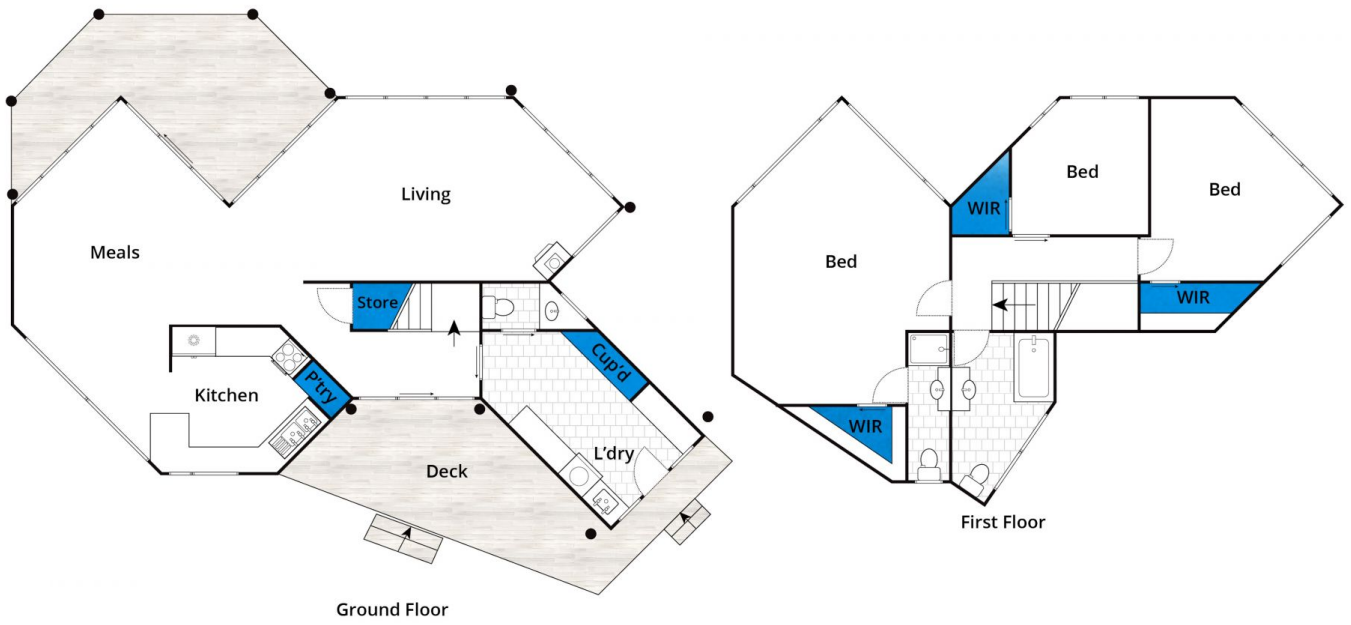

Whilst bwrn.com.au has made every attempt to ensure the accuracy of the floor plan contained here, measurements are approximate and no responsibility is taken for any error, omission, or mis-statement. This plan is for illustrative purposes only.

45 Pearse Road, Aireys Inlet

