



## 15 Smithers Street LORNE VIC

4 2 4

This meticulously renovated, low-maintenance 4BR brick residence is designed to enhance your lifestyle and cater to every generation of your family. Step inside to discover a highly practical floor plan where each level operates almost as a self-contained haven. Each level features two double bedrooms, a modern bathroom, and a generous living area, ensuring flexibility for extended families, visiting guests, or even the possibility of paying guests. The upper level hosts a contemporary main kitchen while a secondary kitchenette on the lower level eases meal preparation when everyone's gathered. The contemporary finishes mean you can move in with confidence as this home requires nothing further to spend. Start your day on the sunny east-facing front sundeck, which doubles as an inviting outdoor living space.

[For full version visit the website](https://www.greateoceanproperties.com.au/sale/vic/great-ocean-rd-otway-ranges/lorne/residential/house/8267201)

**Type** : House  
**Land Size** : 610 sqm  
**View** : <https://www.greateoceanproperties.com.au/sale/vic/great-ocean-rd-otway-ranges/lorne/residential/house/8267201>



**Marty Maher**  
0352200000



**Mim Atkinson**  
0352200000

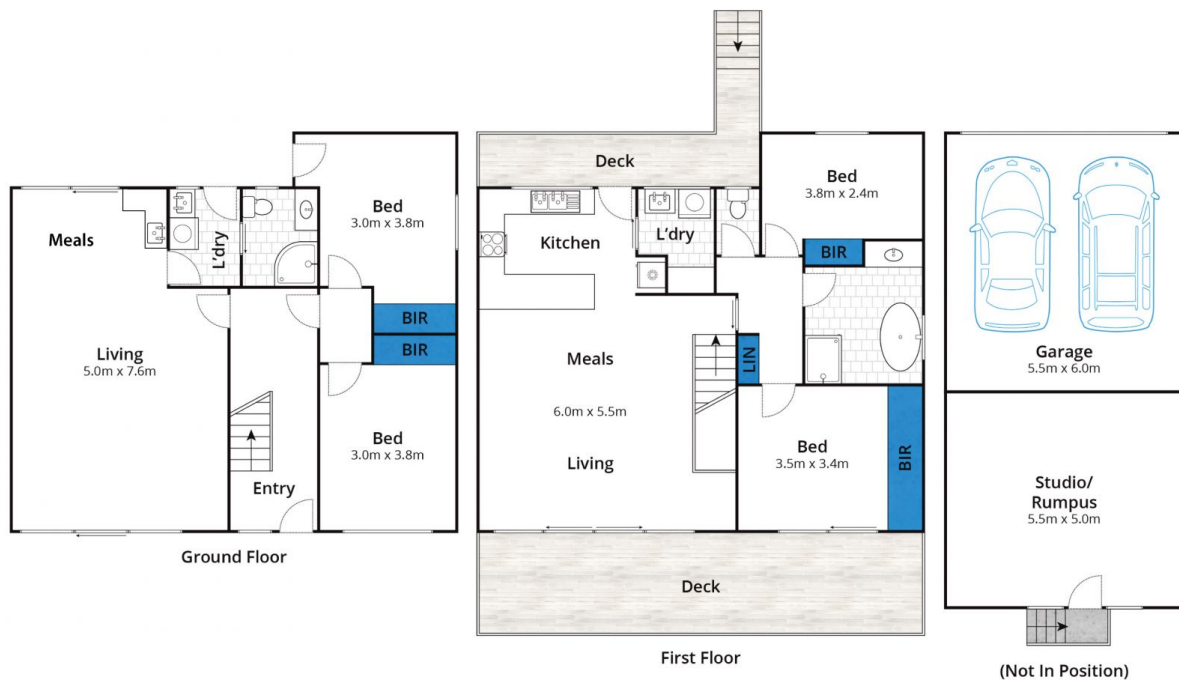

Approx. House Area 176m<sup>2</sup>

Whilst [bwrn.com.au](http://bwrn.com.au) has made every attempt to ensure the accuracy of the floor plan contained here, measurements are approximate and no responsibility is taken for any error, omission, or mis-statement. This plan is for illustrative purposes only.

**15 Smithers Street, Lorne**

greatoceanproperties